

STI Stopper II®



PRODUCT OVERVIEW

Larger cover helps prevent malicious or accidental false fire alarms. Physically larger than the Stopper, the Stopper II is a unique device which has helped prevent false fire alarms around the world for more than 30 years, without restricting legitimate operation of devices such as fire alarm break glass call points. It is ideal for schools, colleges, hospitals, nursing homes, hotels and all public buildings where there is a history or a threat of false fire alarms.

HOW IT WORKS

The Stopper II consists of a clear, tamperproof, tough polycarbonate cover and frame that retrofits over the break glass call point. When lifted to gain access to the break glass, its optional battery powered integral sounder emits a piercing 95 dB or 105 dB (at 1 metre). Immediate attention is drawn to the area and the prankster will either run or be caught.

KEY FEATURES

General Information

- Larger cover helps prevent malicious or accidental false fire alarms.
- Three year guarantee against breakage of polycarbonate in normal use (one year on electromechanical and electronic components).

Design

- Prevents false fire alarms without hindering legitimate operation of a manual call point in the event of an emergency.

Construction

- Tough polycarbonate housing can withstand the severest of knocks.

Installation

- A simple 4 fixing installation can retrofit over existing device.
- Can accommodate flush or surface mounted applications.
- Polycarbonate tested -40°C (-40°F) to 49°C (120°F).

Electronics

- Available with or without a 95 dB integral sounder, powered by a 9V PP3 battery (included).
- Optional 12-24 VDC powered units.

Options

- Break seal facility option for added security.
- Available in a range of colours.
- Custom labelling available.



For more information, call +44 (0)1527 520 999 or visit www.sti-europe.com



**Safety Technology
International (Europe) Ltd**

STI Stopper II®

Dimensions and Technical Information

MODELS AVAILABLE

STI-1200	Stopper II flush mounted without integral sounder
STI-1230	Stopper II surface mounted without integral sounder (includes 50mm spacer)
STI-1100	Stopper II flush mounted with integral sounder
STI-1130	Stopper II surface mounted with integral sounder (includes 50mm spacer)
STI-1200A	Stopper II with 4 inch deep enclosed back box
STI-1200A-HTR	Stopper II Heated Enclosure with 4" Deep Back Box 110 VAC
STI-1200A-HTR240	Stopper II Heated Enclosure with 4" Deep Back Box 240 VAC

Accessories:

STI-3100	50mm spacer (supplied with STI-1130 & STI-1230)
STI-1280	Backplate (for irregular surfaces)
STI-BS	Break Seals (quantity 10)
STI-HK3	Replacement heater

Options:

COLOURS AVAILABLE	For green, blue or yellow add -G, -B or -Y (e.g. STI-1200-G for Stopper II flush mounted without integral sounder in green)
--------------------------	--

SECURITY

NB: Break Seal facility, add -BS

The Stopper II is supplied in red with operating instructions:
'IN CASE OF FIRE - LIFT COVER BREAK GLASS'.
Alternative and custom markings available.

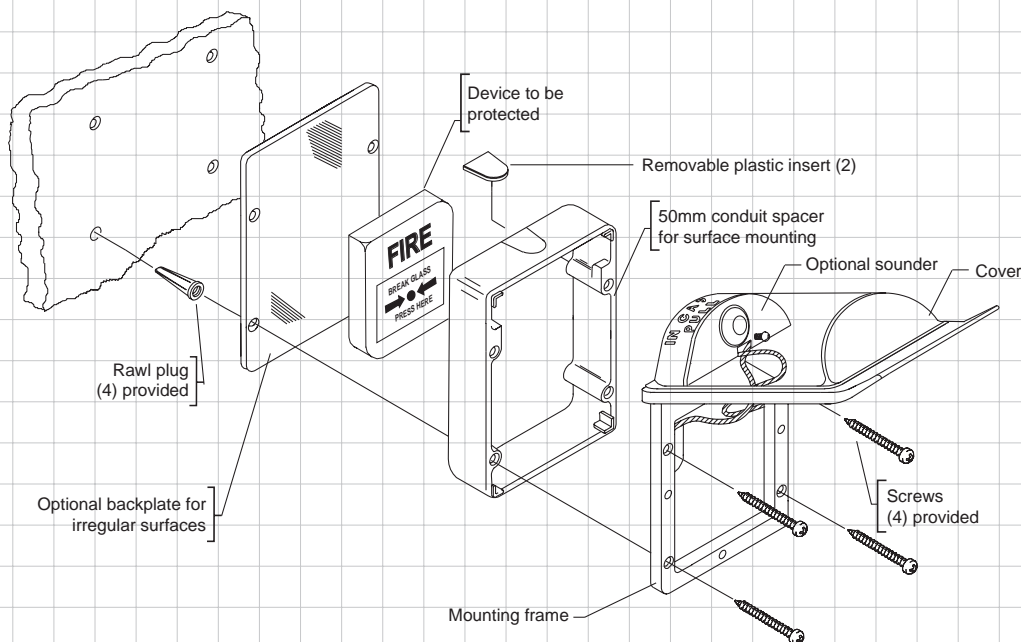
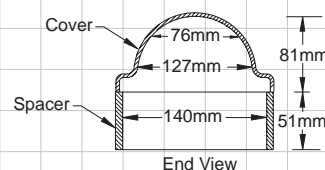
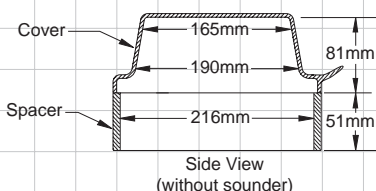
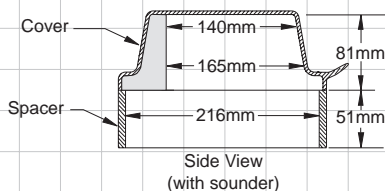
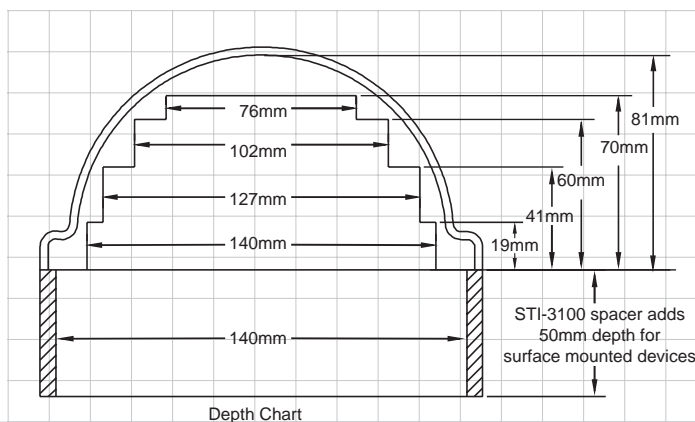

Safety Technology International (Europe) Ltd

UK Office

Unit 49G Pipers Road
Park Farm Industrial Estate
Redditch, Worcestershire
B98 0HU, England

Tel: +44 (0)1527 520 999
Fax: +44 (0)1527 501 999
info@sti-europe.com
www.sti-europe.com

USA Head Office

2306 Airport Road
Waterford, Michigan
48327 - 1209

Tel: +248-673-9898
Fax: +248-673-1246
Toll-free: 0800-888-4STI
info@sti-usa.com
www.sti-usa.com