

RF-7220-07-1 Wireless Outdoor Siren Installation Sheet

EN

1

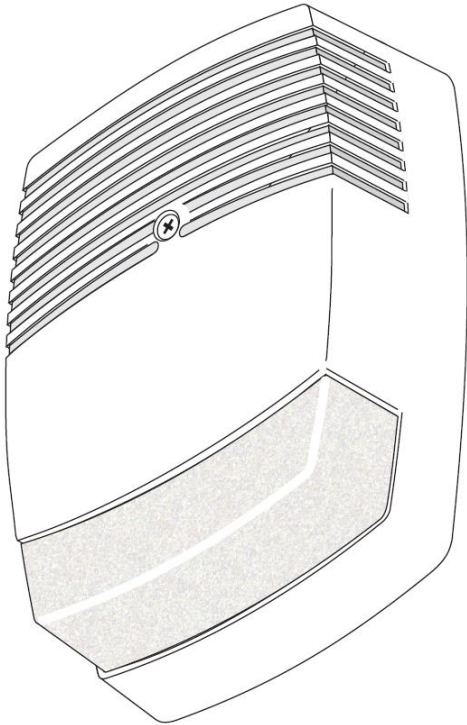

2

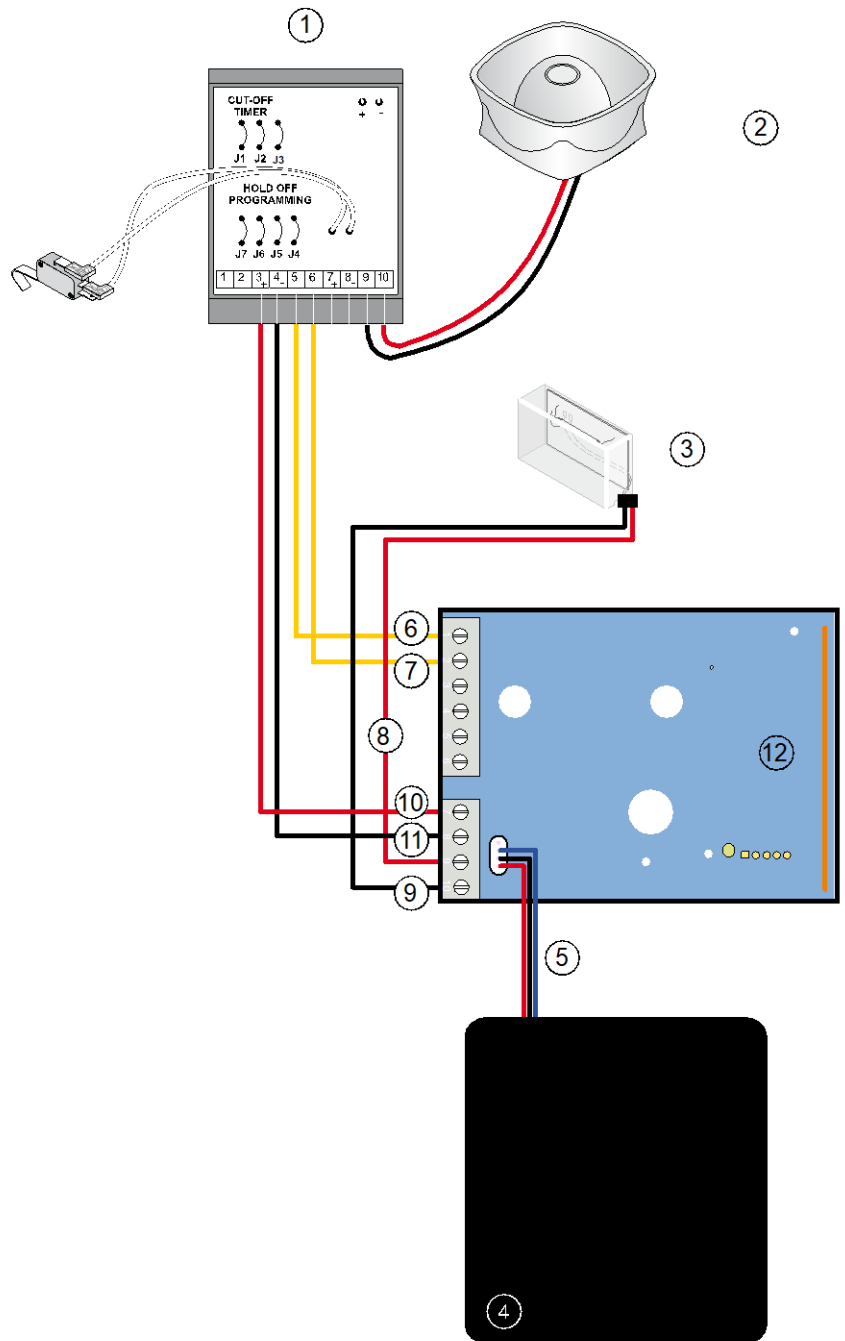

3

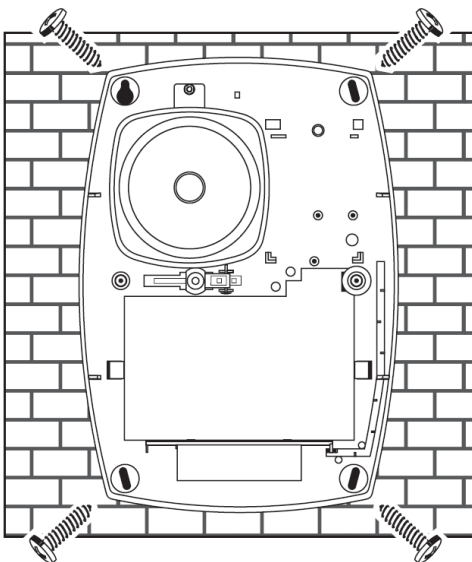

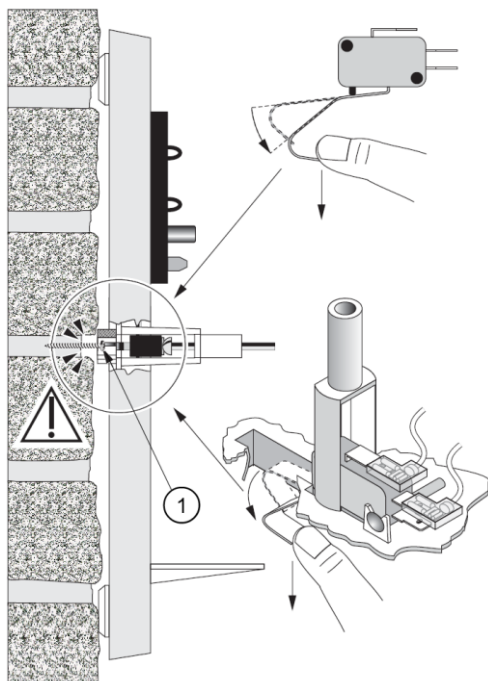

EN: Installation Sheet

Introduction

The RF-7220-07-1 model is designed as a supervised outdoor siren for supported panels. Some panels may require a wireless expansion module.

Up to four (4) RF-7120-07-1, RF-7220-07-1, and RF-IO100-K4 can be installed per panel.

Wiring diagram

Figure 2

- | | |
|--|-----------------------------|
| (1) Siren PCB | (7) Tamper |
| (2) Speaker | (8) Beacon + (red) |
| (3) Beacon | (9) Beacon - (black) |
| (4) 4X lithium battery pack (not included) | (10) Siren driver + (red) |
| (5) IO module power cable (black) | (11) Siren driver - (black) |
| (6) Tamper | (12) IO module PCB |

Learning-in instructions

You have to learn-in the siren before mounting it to the desired position. In order to add a wireless siren to the system perform the following steps:

1. Connect to the panel Web Server (either via WiFi Discovery Mode, WiFi LAN, Ethernet LAN, or the UltraSync + app).
2. Enter your username and password, by default this is "installer" and "9713", then click Sign In.
3. Click Settings.
4. Click Zones.
5. Click "Select Zone to Configure" to set the zone number.
6. Under "Transmitter Type" select "Outdoor Siren".

7. Click Learn.
8. Open the tamper switch of the outdoor siren then power it up by plugging in J2.
9. Wait for the module LED to blink on yellow, then off.
10. Within 5 seconds after the LED switches off, close **front AND rear** tamper switches for 0.5 to 1 second, then open again.
11. LED will flash green once to indicate it has been learnt successfully. If LED flashes any other colour, disconnect J2 power cable, click Remove, and try again from step 5.
12. The screen will indicate the module has been learnt and a serial number will appear. Read the pop up messages.
13. Tick "Enable Tamper" if the outdoor siren box tamper is required. Box tampers and low battery are reported on the zone number selected during learning.

For Outdoor Siren: Output 1 will follow system siren, Output 2 will follow system strobe.
14. Click Save.

	System Zone			Onboard Output	
	#1 I/O Module	#2 Input 1	#3 Input 2	#1	#2
Outdoor Siren	Tampers / Low battery	n/a	n/a	Supervised Siren	Supervised Strobe

Mounting the siren

Mount base with four 3.5 x 25 mm pan head screws (see *Figure 3*). Use wall anchors as required (only four provided, not to be used with tamper).

Pay attention to the precise placement of the tamper switch against the wall. To comply with an EN50131-4 grade 2 installation, you must take special care of positioning the tamper switch lever to the wall, and insert a 3.5 x 32 mm pan head screw in the wall opposite to the tamper switch lever. This screw has to be adjusted in height in order to press adequately on the tamper switch lever so that the microswitch is in a "closed" position and resting on the screw's head instead of the wall (see *Figure 4*, position 1). The siren needs to signal a tamper alarm when the unit is taken more than 5 mm from its mounting surface (see *Figure 4*).

Siren configuration

To allow the IO module to control the output on the outdoor siren, you need to cut jumper J3 (see *Figure 2*, item 1), and then optionally J1 and/or J2.

Jumper 3 is a start-up protection. Jumpers 1 and 2 are responsible for timer settings, and you can cut one of them or both, according to the table below.

Timer setting		
Time	J1	J2
3 minutes (ex-factory)		
5 minutes	✂	
10 minutes		✂
20 minutes	✂	✂

Safety instructions

WARNING: Do not open the flash housing. Risk of high voltage.

Battery replacement and removal

Caution: Batteries can explode or cause burns when recharged, incorrectly (dis)assembled, replaced by an incorrect type, or exposed to fire or high temperatures.

Dispose of used battery according to battery directive instructions and/or as required by local laws. Keep away from children.

To remove the batteries from the outdoor siren, please pull the black plastic strap that holds the battery pack. Only replace the batteries with the standard lithium battery pack BS7201-N. Do not use a different type of lithium batteries.

Note: The lithium battery pack BS7201-N is not included with the siren, and must be purchased separately.

Specifications

Type of warning device	External, self-powered
Type of acoustic output	Tone
Number and type of batteries	BS7201-N, 4-cell custom battery pack, lithium (purchased separately)
Battery capacity	12.5 Ah
Electronics, board operating voltage	3.0 VDC
Siren/flash light part operating voltage	12.0 VDC
Minimum voltage	8.0 VDC
Nominal voltage	12.0 VDC
Maximum voltage	13.2 VDC
Low voltage failure threshold for siren	8 V
Low voltage failure threshold for electronics	2.5 V
Battery lifetime (typical)	3 years*
Wireless operating frequency	433.050 to 434.790 MHz
Maximum power output (E.R.P.)	10 dBm
Current consumption – IO module (typical)	140 µA at 3.0 VDC ± 10%
Current consumption – siren (typical)	340 mA at 12.0 VDC ± 10%
Current consumption – beacon (typical)	74 mA at 12.0 VDC ± 10%
Peak current consumption	Siren sounding peak (sounding+strobe): 450 mA PCB peak: 50 mA, quiescent: 120 uA

Environmental

Operating temperature	-25 to +50°C
Humidity	max 95%, noncondensing
Shipping weight	2.3 kg
Enclosure dimensions	310 x 222 x 91 mm

* Assumption: maximum 20 siren activations of 3 minutes and beacon activations of 15 minutes per year.

Regulatory information

Manufacturer PLACED ON THE MARKET BY:
Carrier Fire & Security Americas Corporation Inc.
13995 Pasteur Blvd
Palm Beach Gardens, FL 33418, USA
AUTHORIZED EU REPRESENTATIVE:
Carrier Fire & Security B.V.
Kelvinstraat 7, 6003 DH Weert, Netherlands

Certification



EN 50131-5-3:2017
EN 50131-4:2019
Security Grade 2, Environmental Class III
Tested and certified by Telefication B.V.

Product warnings and disclaimers



THESE PRODUCTS ARE INTENDED FOR SALE TO AND INSTALLATION BY QUALIFIED PROFESSIONALS. CARRIER FIRE & SECURITY CANNOT PROVIDE ANY ASSURANCE THAT ANY PERSON OR ENTITY BUYING ITS PRODUCTS, INCLUDING ANY "AUTHORIZED DEALER" OR "AUTHORIZED RESELLER", IS PROPERLY TRAINED OR EXPERIENCED TO CORRECTLY INSTALL FIRE AND SECURITY RELATED PRODUCTS.

For more information on warranty disclaimers and product safety information, please check <https://firesecurityproducts.com/policy/product-warning/> or scan the QR code.

REACH

Product may contain substances that are also Candidate List substances in a concentration above 0.1% w/w, per the most recently published Candidate List found at ECHA Web site.

Safe use information can be found at <https://firesecurityproducts.com/en/content/intrusion-intro>



2012/19/EU (WEEE directive): Products marked with this symbol cannot be disposed of as unsorted municipal waste in the European Union. For proper recycling, return this product to your local supplier upon the purchase of equivalent new equipment, or dispose of it at designated collection points. For more information see: recyclethis.info



This product may contain a battery that cannot be disposed of as unsorted municipal waste in the European Union. See the product documentation for specific battery information. The battery is marked with this symbol, which may include lettering to indicate cadmium (Cd), lead (Pb), or mercury (Hg). For proper recycling return the battery to your supplier or to a designated collection point. For more information see recyclethis.info

Carrier Fire & Security hereby declares that this device is in compliance with the applicable requirements and provisions of all applicable rules and regulations, including but not limited to the Directive 2014/53/EU. For more information see: firesecurityproducts.com

Product documentation



Please consult the following web link to retrieve the electronic version of the product documentation.

This link will guide you to the EMEA regional contact page. On this page you can request your login to the secured web portal where all manuals are stored.

<https://firesecurityproducts.com/en/contact>

Contact information

firesecurityproducts.com or www.aritech.com