

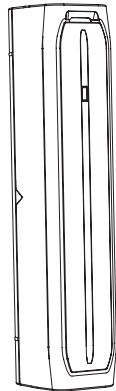

## W-XP-R

### Installation Instructions



Wireless Expander, Repeater & Bridge

[www.orisec.co.uk](http://www.orisec.co.uk)

## Introduction

The W-XP-R Wireless Expander, Repeater & Bridge can function as:

- A Wireless Expander
- A Wireless Repeater
- A Wireless Bridge

When used as a wireless Expander it can be connected anywhere on the Orisec bus-network to add wireless capability to hard-wired / hybrid systems.

When used as a Wireless Repeater it can effectively double the wireless range of a system.

When used as a Wireless Bridge it can join a subsystem that is connected to a PZX-10 expander to a control panel equipped with a wireless interface.

## 1 Installation

**IMPORTANT:** Always mount the W-XP-R Vertically.

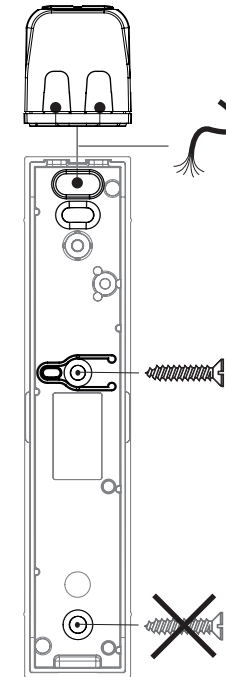
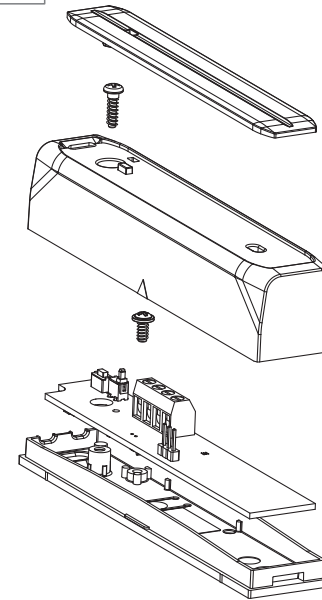
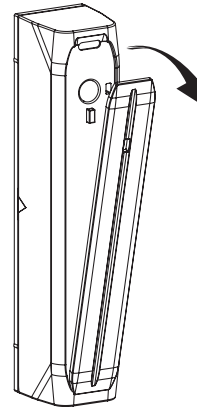

Fit screw here to activate wall tamper when removed from mounting surface.

**ONLY use the screws provided. Ensure the screw head does not touch the PCB.**

**Do Not Fit Screw Near Antenna**

## Key Features

- Up to 100 Wireless Zones\*
- Up to 100 Keyfobs\*
- Wireless Expander
- Wireless Repeater
- Wireless Bridge
- 2 Way Wireless Communications
- Digital Thermometer
- Frequency Hopping Technology
- Grade 2
- White, Brown or Anthracite
- Only 25mm Wide

\*Panel Dependent

## 2 Wireless Expander

To operate as a Wireless Expander connect to the control panel network as shown below.

Each expander must be assigned a different address which can be set to 1, 2 or 3 using the jumper link as shown below.

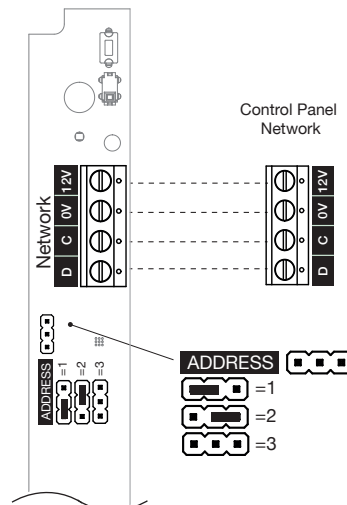

## 3 Wireless Repeater

To operate as a Wireless Repeater connect the 12V and 0V to an auxiliary power source as shown below.

The repeater should then be learned on the control panel as follows:

- Enter engineering mode
- Select "Setup Wireless Zones"
- Navigate to an available zone
- Scroll down to "Learn"
- Press and hold the "Learn" button on the W-XP-R for 1 second.

**NOTE:** For tamper monitoring on the W-XP-R program the zone as 'W-KP/Bell/TR'.

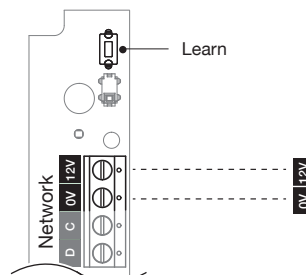

## 4 Wireless Bridge

To operate as a Wireless Bridge connect the W-XP-R to the Orisec PZX-10 or PRX-INT as shown.

Only one networked device can be added to a single W-XP-R operating as a wireless bridge.

An W-XP or W-XP-R needs to be installed locally at the Control Panel.

The bridge should then be learned on the control panel as follows:

- Enter engineering mode
- Select "Setup Wireless Zones"
- Navigate to an available zone
- Scroll down to "Learn"
- Press and hold the "Learn" button on the W-XP-R for 1 second.

**NOTE:** For tamper monitoring on the W-XP-R program the zone as 'W-KP/Bell/TR'.

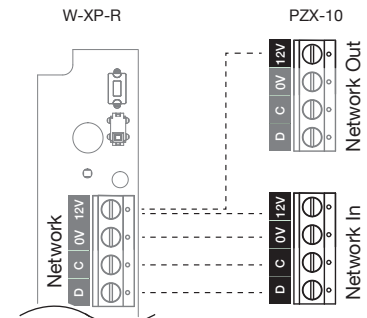
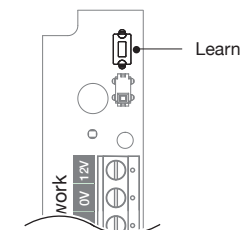

Once configured the PZX-10 will be seen in "Confirmed Devices".

Please refer to the PZX-10 Installation Manual for additional information.

## 5 Connecting an Orisec Prox Reader

The W-XP-R can also be used to wirelessly connect an Orisec Prox reader to an Orisec system.

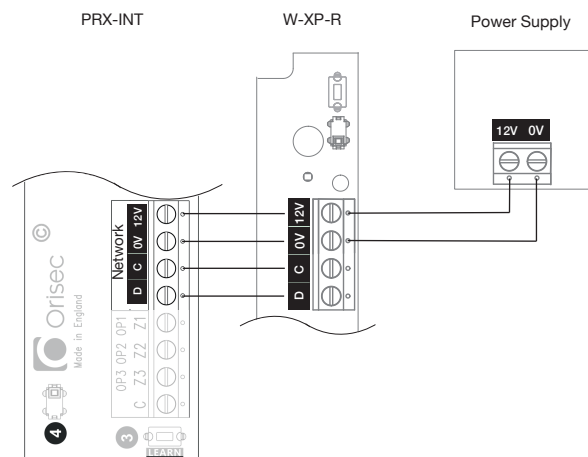

## Regulatory



WEEE Directive: 2012/19/EU  
Compliant: This symbol indicates that according to local laws and regulations, this product should not be disposed of as municipal/household waste. Instead, it should be disposed of at the appropriate collection points designated for the recycling of electrical and electronic equipment, or returned to Orisec upon purchase of new replacement products.

## RoHS

RoHS Directive: 2011/65/EU  
Compliant: Orisec declares that this product complies with and conforms to RoHS legislation that it does not contain more than the agreed levels of: Lead (Pb), Cadmium (Cd), Mercury (Hg), Hexavalent chromium (Cr6+), Polybrominated biphenyls (PBB), Polybrominated diphenyl ethers (PBDE)

## Specification

Dimensions (whd) mm	25 x 123 x 29
Housing Thickness	2.5mm
Operating Temperature	-20°C to +55°C
Storage Temperature	-35°C to 60°C
Maximum Humidity	95% non-condensing
Product Weight	50g
Packed Weight	60g
Maintenance	Annual Installer Check
Frequency	868.65 MHz and 869.15 MHz

## Standards and Approvals

Security	PD 6662:2017
	EN 50131-2-8:2016
	EN 50131-5-3:2017
	Grade 2, Class II
EMC / False Alarm Immunity	
EMC Immunity:	EN 50130-4:2011
	+A1:2014
	EN 301 489-3 V1.6.1
Radiated Immunity:	80MHz to 2.7GHz
Electrostatic Discharge:	+/- 8kV
Fast Transient Immunity:	2kV
Radiated Emissions:	EN 55032:2015
	EN 300 220-2 V2.3.2
Conforms to European Union (EU) Electro-Magnetic Compatibility (EMC) Directive 2014/30/EU	
EMC Environment: Residential / Commercial / Light Industrial / Industrial	
Conforms to RE Directive 2014/53/EU	

CE: You can view the product EC Declaration of Conformity here: [orisec.co.uk/compliance](http://orisec.co.uk/compliance)

Manufacturer: Orisec Ltd, 1 St Crispin Way,  
Haslingden, Lancashire. BB4 4PW. United Kingdom

## Warranty

The Orisec W-XP-R is guaranteed against defects in material or faulty workmanship for a period of 2 years from the date of purchase.  
Disclaimer: Orisec will not accept any liability based on a claim that the Orisec W-XP-R failed to perform correctly as it is a component part of an installation and not a complete intruder alarm system.



Designed and Manufactured  
in the United Kingdom

Manufacturer: Orisec Ltd, 1 St Crispin Way,  
Haslingden, Lancashire. BB4 4PW. United Kingdom



UK Based Technical Support:  
t: +44 (0) 1706 398740  
e: [support@orisec.co.uk](mailto:support@orisec.co.uk)