



## **VELA TX 220V-3V**

Rolling code radio control, 433.92 MHz, 4 channels  
with inputs for wall buttons.

Dual power-supply: mains 120-240 VAC  
or CR 2032 battery

# WARNINGS

- Installation must be carried out only by qualified technicians in compliance with the electrical and safety standards in force.
- All connections must be made with the power turned off.
- Use suitable cables.
- Do not cut through the aerial (see picture 1.1b)
- A suitably sized disconnection device must be set up on the electric power line that supplies the product.
- Disposal of waste materials must fully respect local standards.

## 1 PRODUCT FEATURES

### 1.1 TECHNICAL DATA

Power supply	Mains 120-240 VAC or CR 2032 battery
Number of TX channels	4
Radio frequency	433,92MHz
Range	120 m in free field
Protection rating	IP20
Operating temp.	-20 +55 °C
Size	52X43X21

Pic.1.1

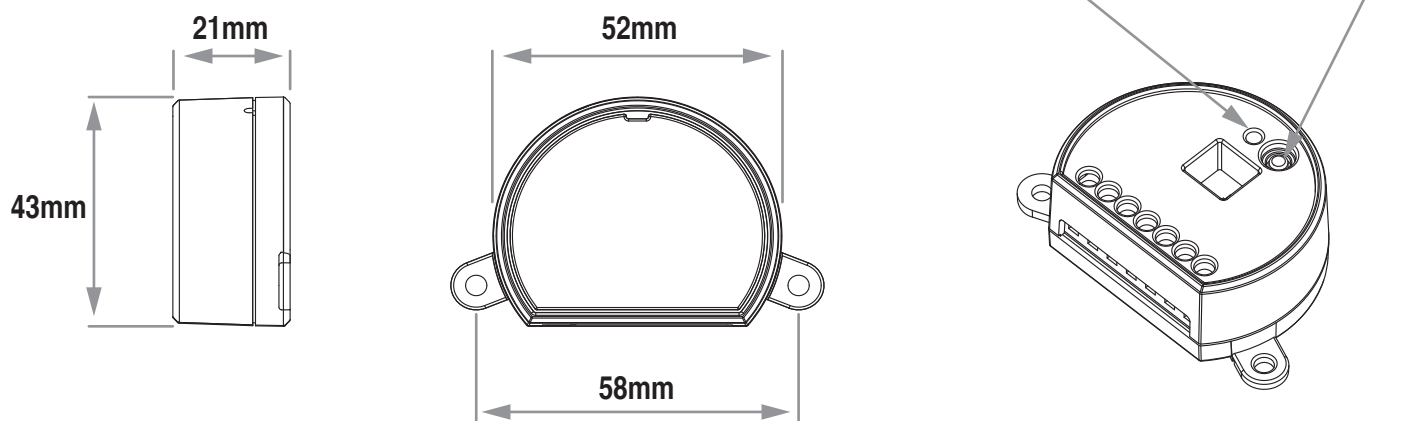

Pic.1.1b

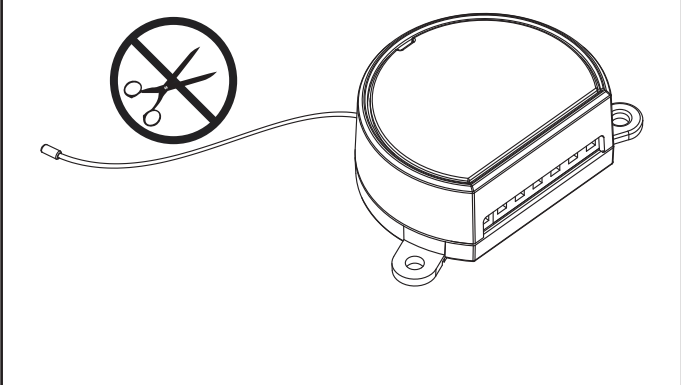

Pic.1.1c

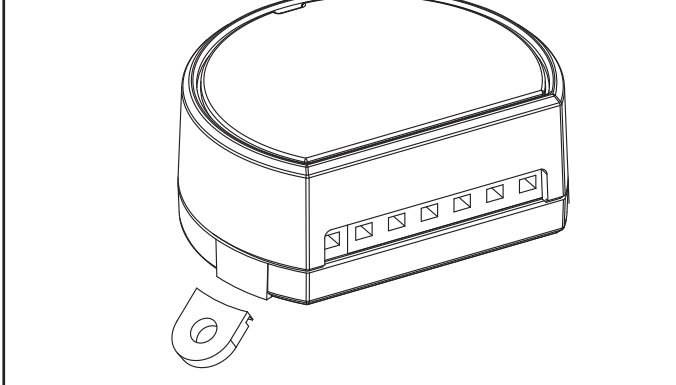

### 1.2 DESCRIPTION

Flush mountable remote control with 4 channels, ideal for transforming wired wall buttons into radio controls. The innovative dual power supply, either from the mains or a battery, allows installation on wire-controlled units or on pre-existing sensors. The ISM (industrial, scientific and medical) radio frequency band guarantees a long range, even through walls and ceilings. Ultra-reduced dimensions with breakable tabs for fixing with screws or for insertion into connection 55 mm diameter boxes.

## 2 ELECTRICAL CONNECTIONS

The transmitting controller can be powered from the grid or by battery. The battery life varies depending on different factors, but it can be estimated at an average of about four years.

**WARNING:** If the transmitting controller is powered from the grid, the battery should not be inserted.

### 2.1 BATTERY POWER SUPPLY

With this type of connection the battery must be inserted into the plastic casing.

**WARNING:** It is possible to connect multiple buttons to the same input with parallel connection.

Pic.2.1

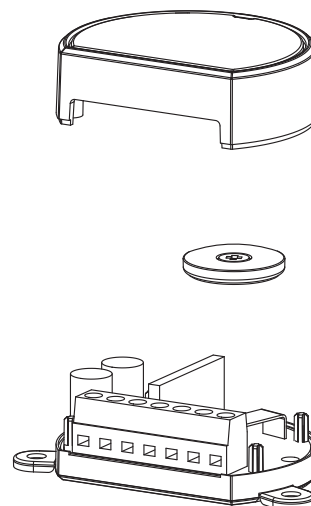
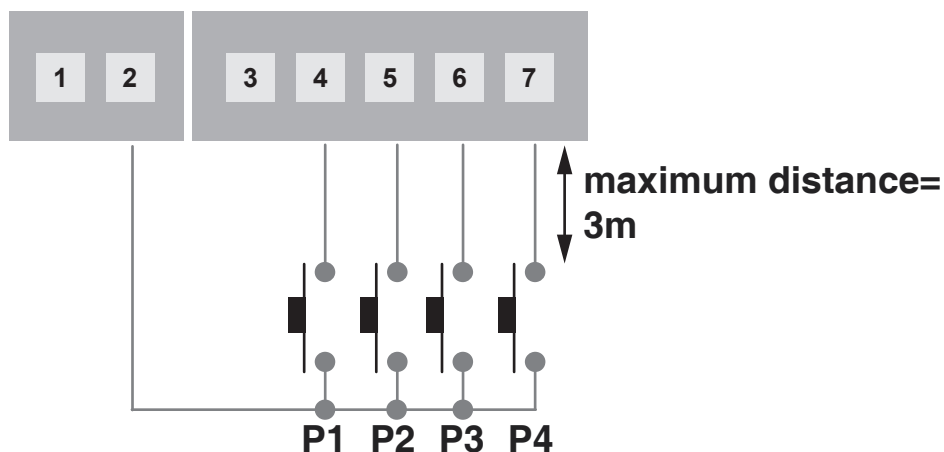

### 2.2 GRID POWER SUPPLY

**WARNING:** It is possible to connect multiple buttons to the same input with parallel connection.

**WARNING:** If the transmitting controller is powered from the grid, the battery should not be inserted.

Pic.2.2

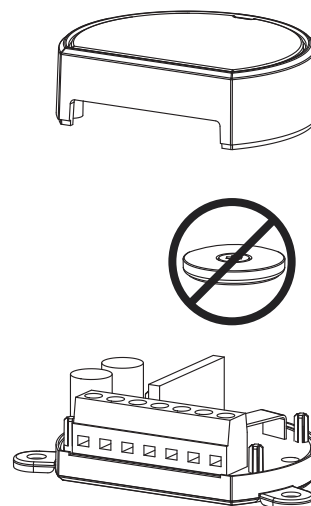
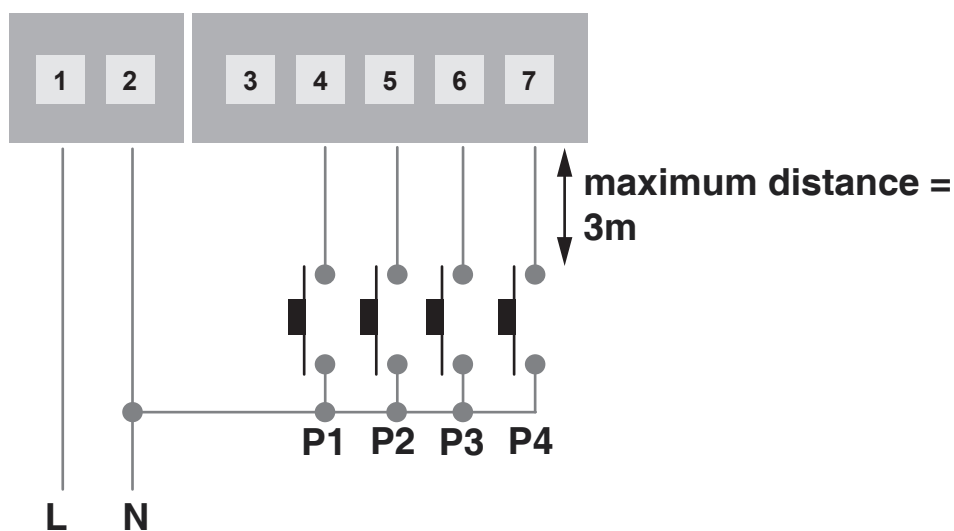

## 3 - RADIO PROGRAMMING

### 3.1 TRANSMITTER PROGRAMMING

Once the wired buttons are connected, the controller behaves like a generic type of transmitter. In order to be able to use it, it must be programmed on a compatible receiver

#### PROCEDURE:

- 1- Activate the receiver on which you want to use the transmitter in "radio programming of generic transmitters" mode and select the function that you want to associate with the key (see receiver manual).
- 2- Press the desired wired button, the receiver's LED flashes 3 times to signal that it has been received.



Sede legale e operativa / Headquarters:

Via del Lavoro, 10  
30030 Salzano (VE) - Italy  
Tel. +39.041.5740374  
Fax +39.041.5740388  
info@venitem.com  
www.venitem.com

AZIENDA CERTIFICATA



DESIGN E  
PRODUZIONE  
IN ITALIA 

ITALIAN DESIGN AND PRODUCTION

V1.0