



Design Registration Number 6305346
Worldwide Patents Pending

INSTRUCTIONS



DR1 Aerosol Dispenser

Designed for Smoke Alarm Testing

Note: Detectareach® is not a disposable product – you simply attach a new can of Detectasmoke®.

Thank you for choosing Detectareach®, we trust that it will give you many years of service.



Detectareach® and Detectasmoke® are registered trademarks of Gas Safe Europe Ltd*

 Scan for more detail



Gas Safe Europe Limited,
Chowley One, Tattenhall, Chester, Cheshire,
United Kingdom CH3
gassafeurope.com

Instructions for use:

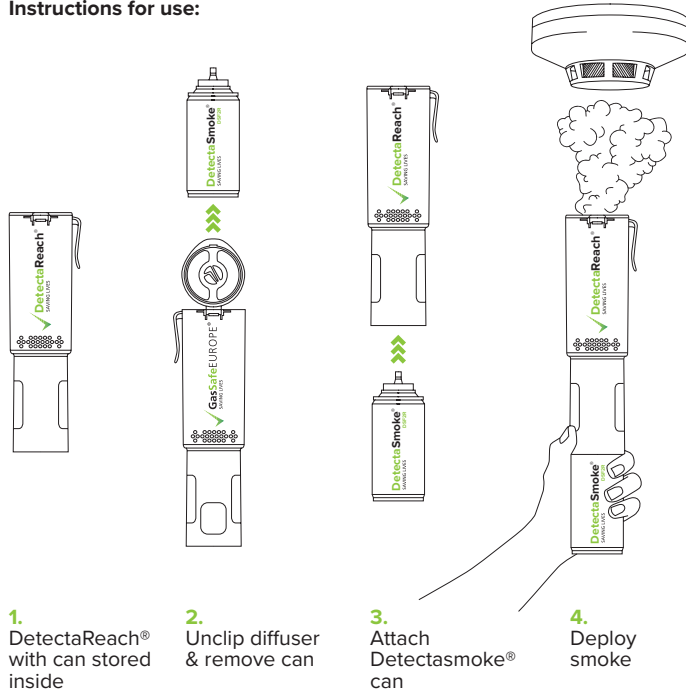

Saving the planet
Eco Friendly – reducing landfill
Ultra-low residue formula

* For more information and helpful videos please visit our website

Detectareach® Directions:

- For use with Detectasmoke® DSF2R 150ml aerosol.
- For professional use only.
- Risk assessment recommended prior to use on energised equipment.
- No liability can be accepted for improper use.
- Hold Detectareach® vertically around 30cm from the alarm, depress the actuator for 1 second and wait for the alarm to activate. If the alarm does not activate then repeat. If the alarm still does not activate then it is not working. Check the alarm further and replace as required.





Tip

When not in use detach the can of smoke and insert within the Detectareach® to avoid unwanted triggering of the smoke and to protect the canister from piercing etc from external sources.



Maintenance / Service / Protection

Detectareach® can be wiped clean using mild detergent and water with a damp cloth. When not in use store the can of Detectasmoke® within Detectareach®(fig 1), replacements can be purchased from your distributor or Gas Safe Europe Ltd.



Usage

When the can is empty simply replace the can of Detectasmoke® DSF2R and reuse your Detecareach®. REFILL NOT LANDFILL.



Disposal

Waste can be disposed of at municipal or industrial landfill when complying with local and national regulations.

