

Stopper[®] Station Series



PRODUCT OVERVIEW

These UL listed, multipurpose push button switches cover a wide range of applications both indoors and outdoors (SS2xx7 models only without a cover, all other models require a weatherproof cover for outdoor use). They incorporate a unique, patented design that helps dramatically to prevent accidental activations. A number of standard models are available or custom units can be created to meet specific needs. There are six colour options, ten button activation choices, and the option of standard or custom text in any language.

Because of their superior, patented design combined with quality construction throughout, you can expect outstanding performance for years to come. Protect the switches with an STI protective cover, which carry a three year guarantee against breakage in normal use, one year on electro mechanical and electronic components. For indoor applications, you can order your Stopper Station with a pre-alarm cover to help prevent malicious and accidental activation.

KEY FEATURES

General Information

- Multipurpose push button switches cover a wide range of applications both indoors and outdoors.
- Three year guarantee against breakage of polycarbonate in normal use (one year on electro mechanical and electronic components).

Design

- Unique, curved design helps protect against accidental activation.

Construction

- Station housing moulded of tough polycarbonate.
- UL Listed to U.S. and Canadian safety standards (excludes pneumatic SS2xx8).
- Stainless steel backplate.
- Push buttons are ADA Compliant (excludes SS2xx8).

Installation

- New dual mount can fit industry standard UK, EMEA and USA flush mount electrical boxes.
- All models are supplied with a 12mm worldwide mounting plate/ spacer as standard.
- Various mounting options for US flush, worldwide flush and worldwide surface mounting. See reverse.
- 5VA flammability rating on backplate and spacer.
- Typical working properties of polycarbonate are -40°C to 121°C (-40°F to 250°F).
- Polycarbonate complies with FDA regulations for food contact applications.

Options

- Colour choices: red, green, yellow, white, orange or blue.
- Standard or custom text option.
- Custom text in any language.
- Protect with STI indoor/outdoor protective covers.

STI Stopper®Station Series

Dimensions and Technical Information

BUILD YOUR OWN MODEL

Housing Colour:

00 = Red
10 = Green
20 = Yellow
30 = White
40 = Blue
50 = Orange

Activation:

0 = Key-to-Reset *not available in Orange*
1 = Turn-to-Reset
2 = Key-to-Reset (Illuminated)
3 = Key-to-Activate
4 = Momentary
5 = Momentary (Illuminated)
6 = Momentary (Illuminated)
7 = Weather Resistant Momentary (Illuminated)
8 = Pneumatic
9 = Turn-to-Reset (Illuminated)

Text:

AB = ABORT
EM = EMERGENCY
EX = EMERGENCY EXIT
PO = EMERGENCY POWER OFF
ES = EMERGENCY STOP
EV = EVACUATION
XT = EXIT
PS = FUEL PUMP SHUT DOWN
HV = HVAC SHUT DOWN
LD = LOCKDOWN
PX = PUSH TO EXIT
NT = No Text
ZA = Custom Text

Language:

EN = English
ES = Spanish
FR = French
ZL = Other Language

Button Mounting & Covers Options

- ✓ denotes minimum mounting requirement for Activation Type selected.
✓ denotes additional mounting options available for Activation Type selected.

12mm Mounting Plate/Spacer (supplied as standard)	Surface Mount Back Box Only (KIT-71100A-*)	Surface Mount Back Box & Spacer (KIT-71101B-*)	Activation Type	StopperStation Shield	Universal Stopper® Surface Mount	Universal Stopper® Flush Mount
		✓	0	✓	✓	
		✓	1	✓	✓	
✓	✓		2	✓	✓	✓
		✓	3	✓	✓	
		✓	4	✓	✓	
✓	✓		5	✓	✓	✓
✓	✓		6	✓	✓	✓
	✓		7	✓	✓	
✓	✓		8	✓	✓	✓
✓	✓		9	✓	✓	✓

SS2 -

PLEASE NOTE:

All Stopper Stations are supplied with a 12mm Worldwide Mounting Plate/Spacer to allow flush mounting as standard. To surface mount, please consider the button mechanism depth and consult the backbox options below.

Surface mount options must be purchased separately.

Accessories

KIT-71100A-* Surface Back Box
KIT-71101B-* Surface Back Box with 12mm Mounting Spacer
KIT-102720-* Replacement 12mm Worldwide Mounting Plate/Spacer (one supplied with each model as standard)

*Colour Options: -R = Red, -G = Green, -E = Orange, -Y = Yellow, -W = White, -B = Blue

Note: See table below for mounting requirements for each Activation Type

LT-1UL UL Latching/Timer Module *Not for Pneumatic models*
STI-6517 Stopper®Station Shield
KIT-E10196 N.O. contact for 0, 1, 3 or 4 switch
KIT-M10197H Replacement contact holder for 0, 1, 3 & 4 switch
KIT-E10198 N.C. contact for 0, 1, 3 or 4 switch
KIT-H19030 Two Extra Keys for Activation Option #0
KIT-H18061 Two Extra Keys for Activation Option #2
KIT-H18062 Two Extra Keys for Activation Option #3

Approvals & warranty

TESTING

It has been tested and approved or listed by:

- UL/cUL File No. S7255, excludes SS2xx8 models.
- UL/cUL Type NM suitable for indoor or outdoor use without a cover, SS2xx7 only.
- UL 294 (models used with LT-1UL).
- CSA C22.2 No. 205, excludes SS2xx8 models.
- ADA Compliant (excludes SS2xx3 models).
- SS2xx8 models: UL recognised component UL508, indoor use only.

WARRANTY

Three year guarantee against breakage of polycarbonate in normal use (one year on electro mechanical and electronic components).

CUSTOMISE YOUR TEXT - text option ZA.

CUSTOM TEXT FOR TOP OF HOUSING SHELL: 1 LINE, 13 CHARACTERS MAXIMUM
2 LINES, 20 CHARACTERS EACH (INCLUDES SPACES)

CUSTOM TEXT FOR BOTTOM OF HOUSING SHELL: 1 LINE, 20 CHARACTERS MAXIMUM
NOTE:

White, Orange & Yellow Buttons are supplied with black text
Blue, Red & Green Buttons are supplied with white text

Contact Depth "A"	mm	inches	Contact Depth "A"	mm	inches
SS2xx0	54.864	2.16	SS2xx5	25.4	1.00
SS2xx1	51.816	2.04	SS2xx6	22.225	0.875
SS2xx2	25.4	1.00	SS2xx7	22.225	0.875
SS2xx3	54.102	2.13	SS2xx8	35.56	1.4
SS2xx4	51.816	2.04	SS2xx9	25.4	1.00

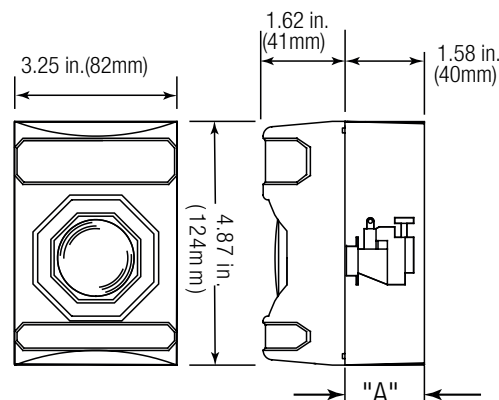

Safety Technology International

Taylor House
34 Sherwood Road
Bromsgrove
Worcestershire
B60 3DR, England

Tel: +44 (0)1527 520 999
Fax: +44 (0)1527 501 999
info@sti-emea.com
www.sti-emea.com

2306 Airport Road
Waterford, Michigan
48327, USA

Tel: 248-673-9898
Fax: 248-673-1246
Toll-free: 800-888-4784
info@sti-usa.com
www.sti-usa.com

STI Series 2000 Stopper® Stations Unique Button Features

Models SS2xx0, SS2xx1, SS2xx3, SS2xx4

- Interchangeable or replaceable N.O. or N.C., SPST gold-plated contact blocks rated for 6 amps @ 600 VAC or 1 amp @ 250 VDC.
- Standard switch includes one N.O. and one N.C. contact. Holds up to three sets of isolated contacts.

Note: Requires KIT-71101B-* and the supplied 12mm spacer (KIT-102720-*) for surface installation. Due to the depth of the contacts, these models cannot be flush mounted.

Models SS2xx2, SS2xx5, SS2xx9

- Two (2) Form "C" contacts, DPDT, rated 10 amps @ 125/250 VAC, 1/2 HP, 6 amps @ 30 VDC.
- 12-24VAC/VDC LED (red, green and white)*

Note: Suitable for flush mounting using the supplied 12mm spacer (KIT-102720-*). If surface mounting is required, order KIT-71100A-* and discard the supplied 12mm spacer.

Model SS2xx6

- Two (2) Form "C" contacts, DPDT, rated 10 amps @ 125/250 VAC, 1/2 HP, 6 amps @ 30 VDC.
- 12-24VAC/VDC LED*
- 100,000 operations.

Note: Suitable for flush mounting using the supplied 12mm spacer (KIT-102720-*). If surface mounting is required, order KIT-71100A-* and discard the supplied 12mm spacer.

Model SS2xx7

- Two (2) Form "C" contacts, DPDT, rated 10 amps @ 125/250 VAC, 1/2 HP, 6 amps @ 30 VDC, -31°F to 150°F (-35°C to 66°C).
- 12-24VAC/VDC LED*
- Weather resistant, suitable for indoor or outdoor use without a cover.
- 100,000 operations.

Note: Only suitable for surface mounting, order KIT-71100A-* and discard the supplied 12mm spacer.

Models SS2xx8

- Switch rating 10 amps resistive at 120-240 VAC and has a timer range: 2 - 60 seconds (± 15%).
- Indoor use only. Not recommended for outdoor/water applications, temperature range of button 15° to 120°F (-9° to +49°C).
- Timer life of over 1,000,000 operations.
- Pneumatic adjustable timer opens or closes a circuit and has a timed delay before reset. No electricity to operate.
- Ideal for security applications.
- 1 Form Z, 1 N.O. and 1 N.C. contact.

Note: Suitable for flush mounting using the supplied 12mm spacer (KIT-102720-*). If surface mounting is required, order KIT-71100A-* and discard the supplied 12mm spacer.

*denotes colour option for spacer and back box kits.

-R = red, -G = green, -E = orange, -Y = yellow, -W = white, -B = blue

★ Power Supply not included

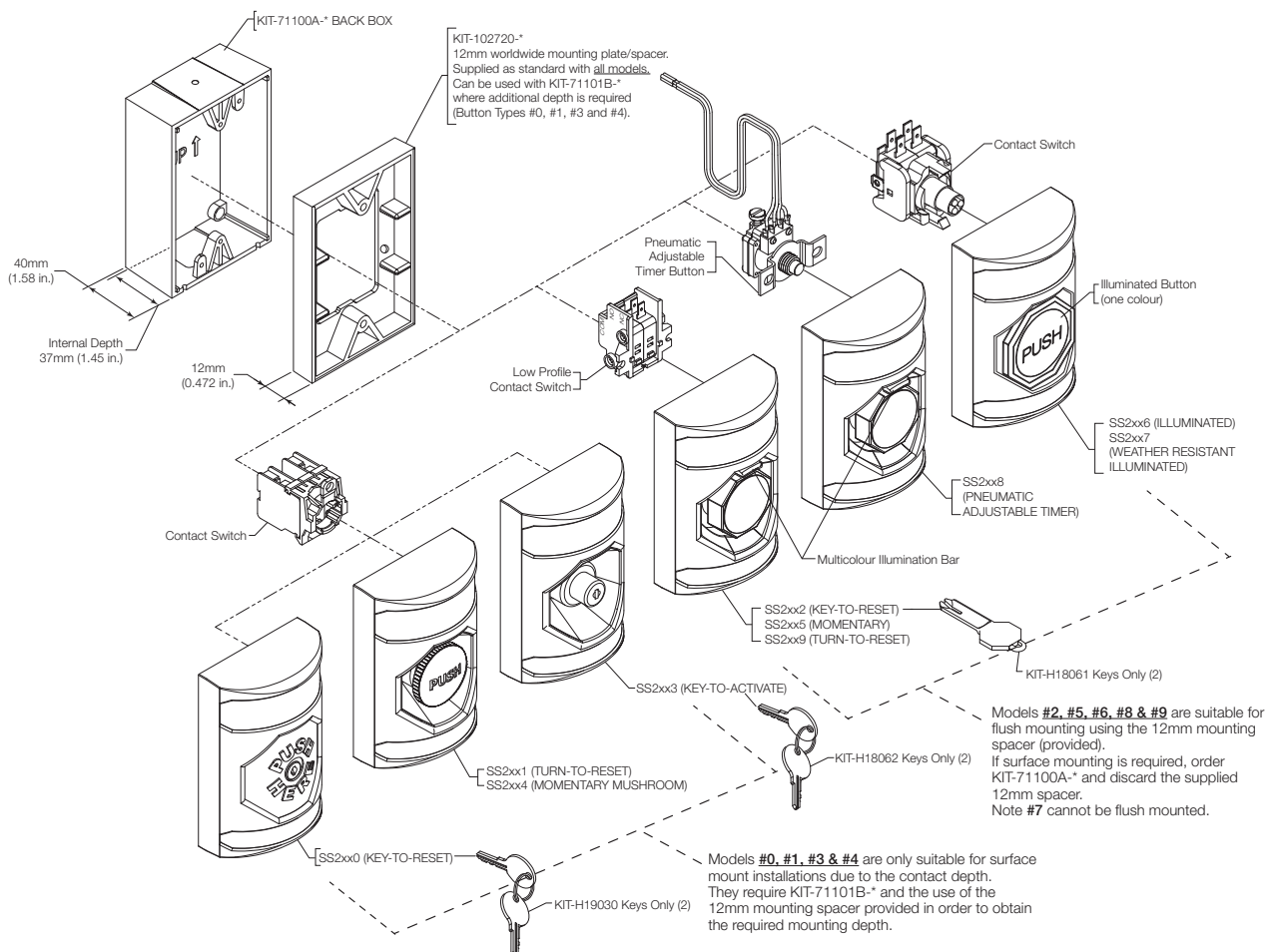

Safety Technology International

UK Office
Taylor House
34 Sherwood Road
Bromsgrove
Worcestershire
B60 3DR, England

Tel: +44 (0)1527 520 999
Fax: +44 (0)1527 501 999
info@sti-emea.com
www.sti-emea.com

USA Head Office
2306 Airport Road
Waterford, Michigan
48327 - 1209

Tel: +248-673-9898
Fax: +248-673-1246
info@sti-usa.com
www.sti-usa.com